

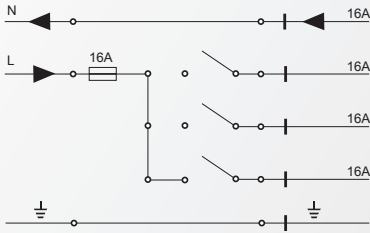

Track System

3-Phase

Wiring Diagrams



Single Phase Connection (230V)

This allows a total load of 16A, corresponding to 3680 Watt, which can be divided among the 3 circuits.

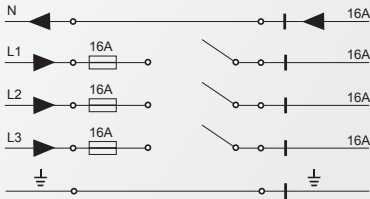

Three Phase Connection (230V)

This allows a total load of 3x 16A, corresponding to 11040 Watt, which can be divided among the 3 circuits, 3x 3680 Watt.

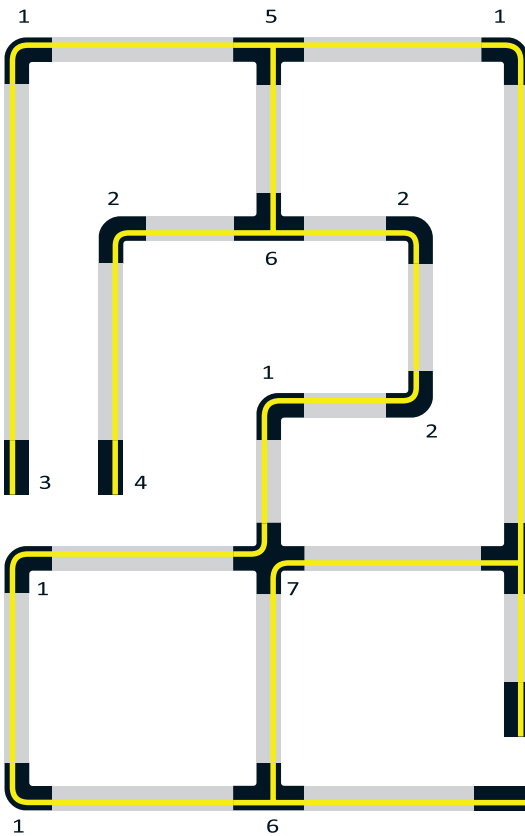

To install a three-phase track there is a wide range of parts available.

- | | | | |
|--|--------------------|--|-------------------|
| | 1. Outside L-joint | | 2. Inside L-joint |
| | 3. Right Live-end | | 4. Left Live-end |
| | 5. Right T-joint | | 6. Left T-joint |
| | 7. X-joint | | |



Live-end with earth on the left L

Live-end with earth on the right R

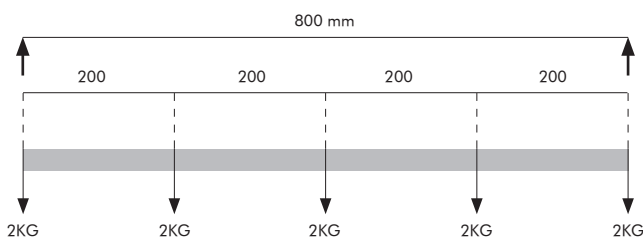

The three phase tracks can take a 2 KG load every 200mm, with a maximum distance of 800mm between the fixing points.

For a 5 KG load every 200mm, the maximum fixing distance has to be 400mm.

Track System

3-Phase

Round

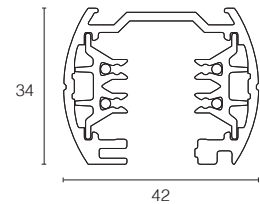
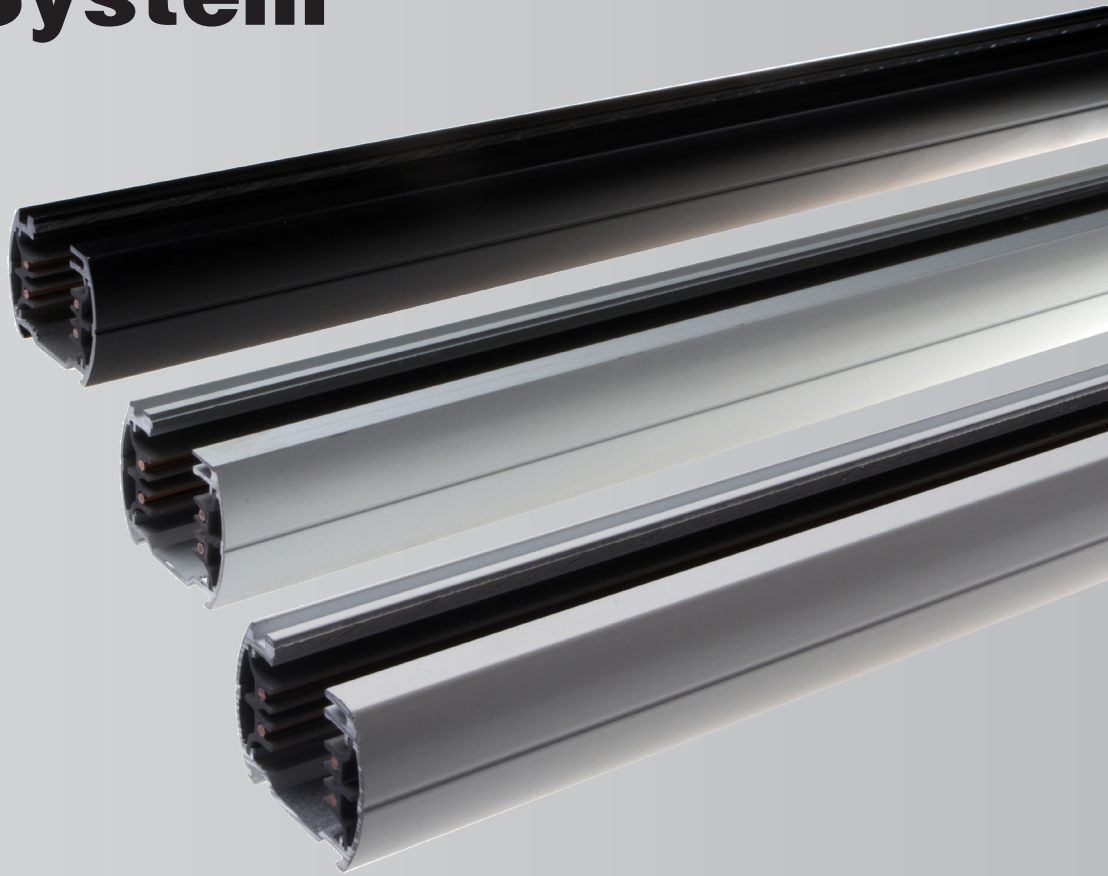

Product List

Article No.	Product Name	Color	Voltage	Current	Length
8.04.1545	3-Phase track round 1 meter	Aluminium ●	230V / 440V	16A	1 Meter
8.04.1544	3-Phase track round 1 meter	White ○	230V / 440V	16A	1 Meter
8.04.1543	3-Phase track round 1 meter	Black ●	230V / 440V	16A	1 Meter
8.04.1548	3-Phase track round 2 meter	Aluminium ●	230V / 440V	16A	2 Meter
8.04.1547	3-Phase track round 2 meter	White ○	230V / 440V	16A	2 Meter
8.04.1546	3-Phase track round 2 meter	Black ●	230V / 440V	16A	2 Meter
8.04.1551	3-Phase track round 3 meter	Aluminium ●	230V / 440V	16A	3 Meter
8.04.1550	3-Phase track round 3 meter	White ○	230V / 440V	16A	3 Meter
8.04.1549	3-Phase track round 3 meter	Black ●	230V / 440V	16A	3 Meter
8.04.2440	3-Phase track round 4 meter	Aluminium ●	230V / 440V	16A	4 Meter
8.04.2439	3-Phase track round 4 meter	White ○	230V / 440V	16A	4 Meter
8.04.2438	3-Phase track round 4 meter	Black ●	230V / 440V	16A	4 Meter

Live-end

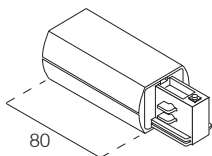

8.04.2408	Right live-end Grey	●
8.04.1573	Right live-end White	○
8.04.1572	Right live-end Black	●
8.04.2409	Left live-end Grey	●
8.04.1575	Left live-end White	○
8.04.1574	Left live-end Black	●

L-joint

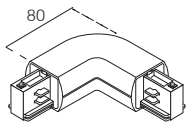

8.04.2411	Inside L-joint Grey	●
8.04.1581	Inside L-joint White	○
8.04.1580	Inside L-joint Black	●
8.04.2412	Outside L-joint Grey	●
8.04.1583	Outside L-joint White	○
8.04.1582	Outside L-joint Black	●

Central connector

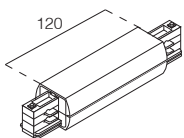

8.04.2410	Central connector Grey	●
8.04.1577	Central connector White	○
8.04.1576	Central connector Black	●

Universal adaptor

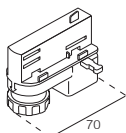

8.04.2407	Universal adaptor Grey	●
8.04.1571	Universal adaptor White	○
8.04.1570	Universal adaptor Black	●

Universal adaptor

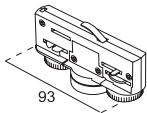

8.04.3529	Universal adaptor Grey	●
8.04.3531	Universal adaptor White	○
8.04.3530	Universal adaptor Black	●

Monopoint

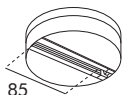

1.05.0300	Monopoint Grey	●
1.05.0242	Monopoint White	○
1.05.0241	Monopoint Black	●

End cap



8.04.2417	End cap Grey	●
8.04.1601	End cap White	○
8.04.1600	End cap Black	●

Mounting bracket

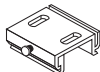

8.04.1589	Mounting bracket	●
-----------	------------------	---

Strength plate 120mm

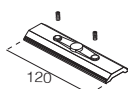

8.04.1586	Strength plate 120mm	●
-----------	----------------------	---

Suspension kit, wire length 2m

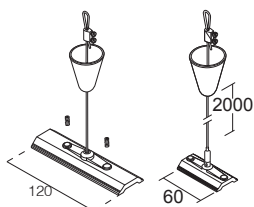

8.04.1588	Suspension kit plate 120mm	○
8.04.1587	Suspension kit plate 120mm	●
8.04.2675	Suspension kit plate 60mm with cable blocker	○
8.04.2676	Suspension kit plate 60mm with cable blocker	●

T-joint

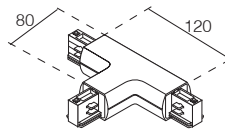

8.04.2414	Right T-joint Grey	●
8.04.1595	Right T-joint White	○
8.04.1594	Right T-joint Black	●
8.04.2415	Left T-joint Grey	●
8.04.1597	Left T-joint White	○
8.04.1596	Left T-joint Black	●

X-joint

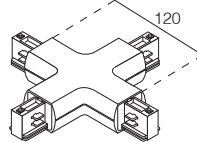

8.04.2416	X-joint Grey	●
8.04.1599	X-joint White	○
8.04.1598	X-joint Black	●

Flexible joint

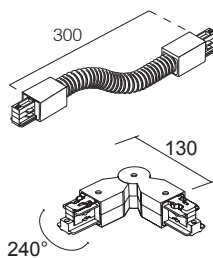

8.04.2413	Flexible-joint Grey	●
8.04.1591	Flexible-joint White	○
8.04.1590	Flexible-joint Black	●
8.04.4075	Flexible-joint Grey	●
8.04.4076	Flexible-joint White	○
8.04.4077	Flexible-joint Black	●

Electrical / mechanical joint

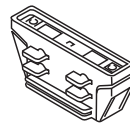

8.04.1579	Electrical straight joint White	○
8.04.1578	Electrical straight joint Black	●
8.04.1619	Mechanical joint White	○
8.04.1618	Mechanical joint Black	●

Track cover

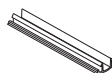

8.04.1603	Track cover 1m White	○
8.04.1602	Track cover 1m Black	●

Mechanical Adaptor

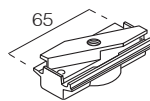

8.04.1605	Mechanical adaptor White	○
8.04.1604	Mechanical adaptor Black	●

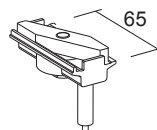

8.04.4078	Mechanical adaptor with cable blocker White	○
8.04.4079	Mechanical adaptor with cable blocker Black	●

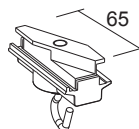

8.04.4080	Mechanical adaptor with hook Grey	●
8.04.4081	Mechanical adaptor with hook White	○
8.04.4082	Mechanical adaptor with hook Black	●

Suspension kit, wire length 2.5m

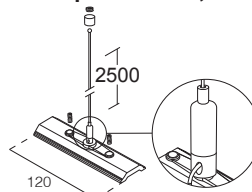

1.01.0210	Suspension kit plate 120mm with cable blocker and fixed ceiling mount	●
-----------	---	---